

STEP 1

Release latches and flip open.



STEP 2

Raise back panel.

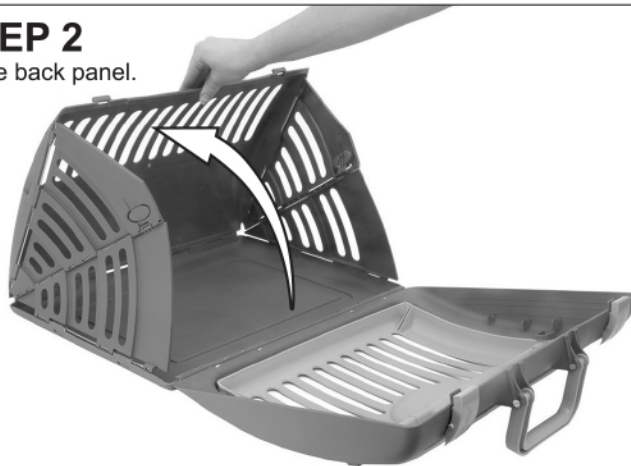

STEP 3

Straighten side panels, and push inner tabs on each side until a click is heard. Once clicked, the side panels will stand on their own.

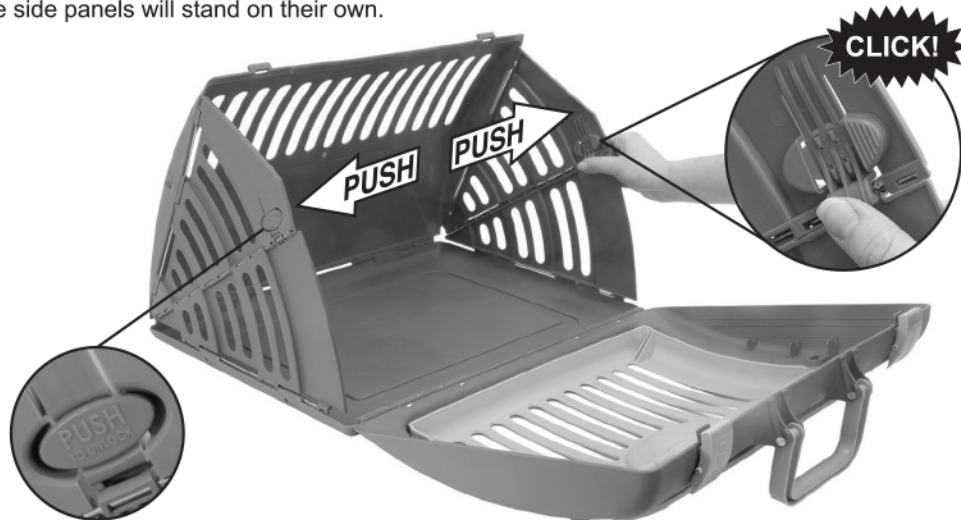

HOW TO COLLAPSE

Push the button while holding the textured tabs to allow the clips to release. Once the clips are released, collapse the side panels.



STEP 4

Close the front panel and secure top latches.



Guide both side panels into the door frame.



Key in notches beneath latches.



Secure latches in place by locking backs of latches into notches.

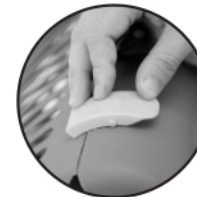

Press down on latches until they click.

DO NOT RETURN THIS UNIT TO THE STORE Please make sure you have all parts prior to assembly.

All SportPet® products include a 6-month limited manufacturer's warranty for defective or missing parts.

If any parts are missing or damaged, **Please email our friendly customer service center at info@sportpet.com**



Because every cat is different, it is important to monitor your cat's behavior with this product. If at any time your cat damages this item, or any portion of this item becomes damaged, remove the damaged portion or discontinue use of the product.